

NOTES:

1. SMALL PARTS SHOULD BE SEALED IN POLYBAG.  
KIT MAY BE BAGGED OR BOXED AND LABELED

REVISIONS			
REV	DESCRIPTION	DATE	APPROVED

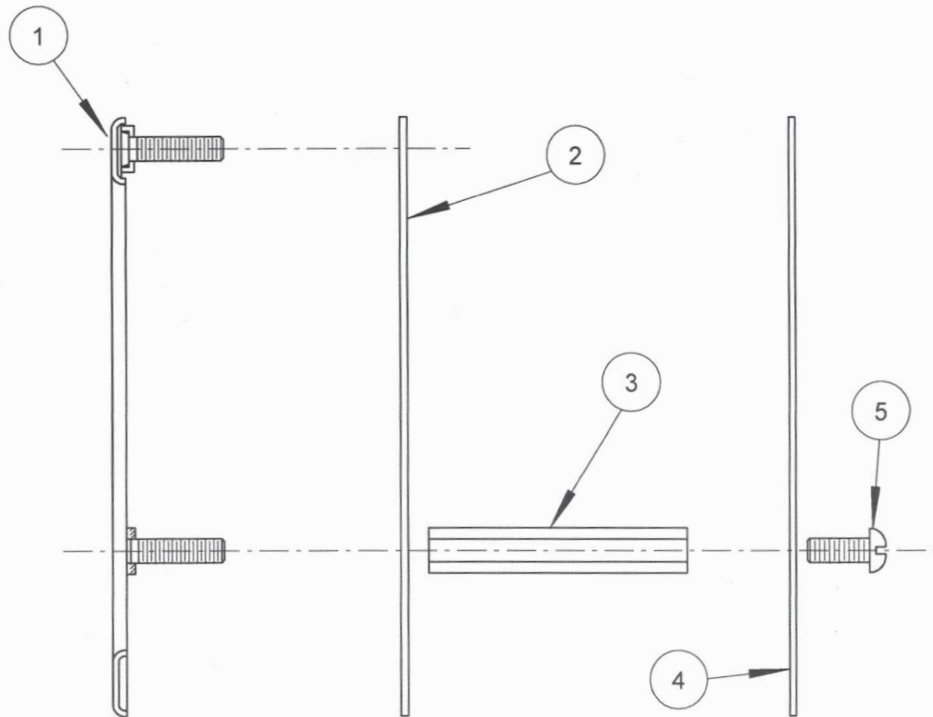

C	COLOR
0	BLACK
1	BLUE
2	RED
3	YELLOW
4	GREEN
5	SILVER
6	WHITE
7	GRAY
8	PURPLE
9	UNFINISHED

ITEM	QTY	DESCRIPTION	PART NUMBER
1	1	WELD RING ASS'Y, 4.5"	121990c4-45-00
2	1	CLAMPING RING, 4.5"	12199091-45-00
3	3	STANDOFF, 5/16" HEX, 10-24 x 2.25	94078360-72-00
4	1	FLUSH MOUNTING BACKUP	12199095-45-00
5	3	SCREW, 10-24 x 1/2"	94078950-16-00
6	1	INSTRUCTIONS - FLUSH MOUNTING KIT, 4.5" M&S	

UNLESS OTHERWISE SPECIFIED DIMENSIONS ARE IN INCHES		MATERIAL:		CONTRACT NO.		<b>PERMA-CAL INDUSTRIES, INC.</b>					
ANGULAR ± 0° 30'		(C) SEE COLOR CHART		DATE						<b>FLUSH MOUNTING KIT 4.5" METAL &amp; SS CASE</b>	
LINEAR .XX ± .01				PREP BY		8/25/2021					
CORNER AND FILLET RAD. .005-.015 REMOVE ALL BURRS				CHECK							
DIAMETERS ON SAME C/L		FINISH:		USED ON:		SIZE	CODE IDENT NO.	DRAWING NO.	REV		
RUNOUT WITHIN _____ FIR						A	59018	121990c5-45-10	N/C		
✓ SURFACE ROUGHNESS USAS B46.1				FILE NAME:		SCALE	WEIGHT	SHEET	1 OF 1		
				121990c5-45-10							